

*Ariyana*  
CONVENTION CENTRE  
MANAGED BY  FURAMA



# CAPACITY

The Ariyana Convention Centre is a leading destination for conventions, trade shows, and exhibitions. We are committed to delivering excellent service and exceeding our clients' and guests' expectations at every event.



Meeting Rooms	Dimension (LxWxH) m	Area m <sup>2</sup>	Theatre (persons)	Dinner (persons)	Classroom (persons)	U-Shape (persons)
Ariyana Grand Ballroom	63x33x9	2,079	2,500	1,500	1,500	950
Ariyana Ballroom 1	18x33x9	594	500	400	400	250
Ariyana Ballroom 1 (section 1a)	18x16.5x9	297	280	170	130	80
Ariyana Ballroom 1 (section 1b)	18x16.5x9	297	280	170	130	80
Ariyana Ballroom 2	27x33x9	891	800	650	600	400
Ariyana Ballroom 3	18x33x9	594	500	400	400	250
Ballroom Foyer		1,490				
Hoi An Room	17x8.9x3	151.3	120	90	80	45
Hoi An Room 1	8.5x8.9x3	75.6	50	40	36	25
Hoi An Room 2	8.5x8.9x3	75.6	50	40	36	25
My Son Room	17x8.9x3	151.3	120	90	80	45
My Son Room I	8.5x8.9x3	75.6	50	40	36	35
My Son Room II	8.5x8.9x3	75.6	50	40	36	35
Hue Room	5.4x11.9x3	60	40	30	24	24
Phong Nha Room	5.4x11.9x3	60	40	30	24	24
Ha Long Room	5.4x11.9x3	60	40	30	24	24
Function Room I	9x10.5x2.5	94.5	70	50	50	20
Function Room II	5x4x2.5	20	15	10	10	
Function Room III	9x4x2.5	36	25	15	15	
Function Room IV	9x4x2.5	36	25	15	15	
Function Room V	9x11x2.5	99	70	50	50	25
Function Room VI	9x11x2.5	99	70	50	50	25

# ARIYANA GRAND BALLROOM FLOOR PLAN

## 1ST FLOOR: 63M X 33M

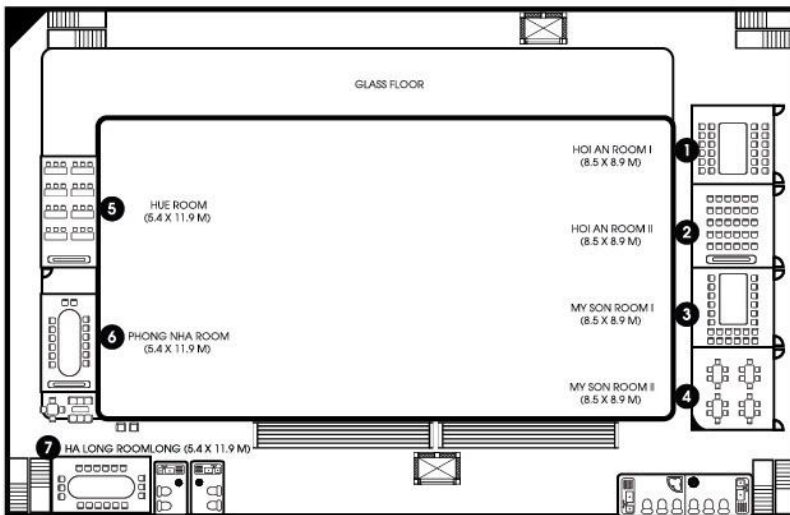
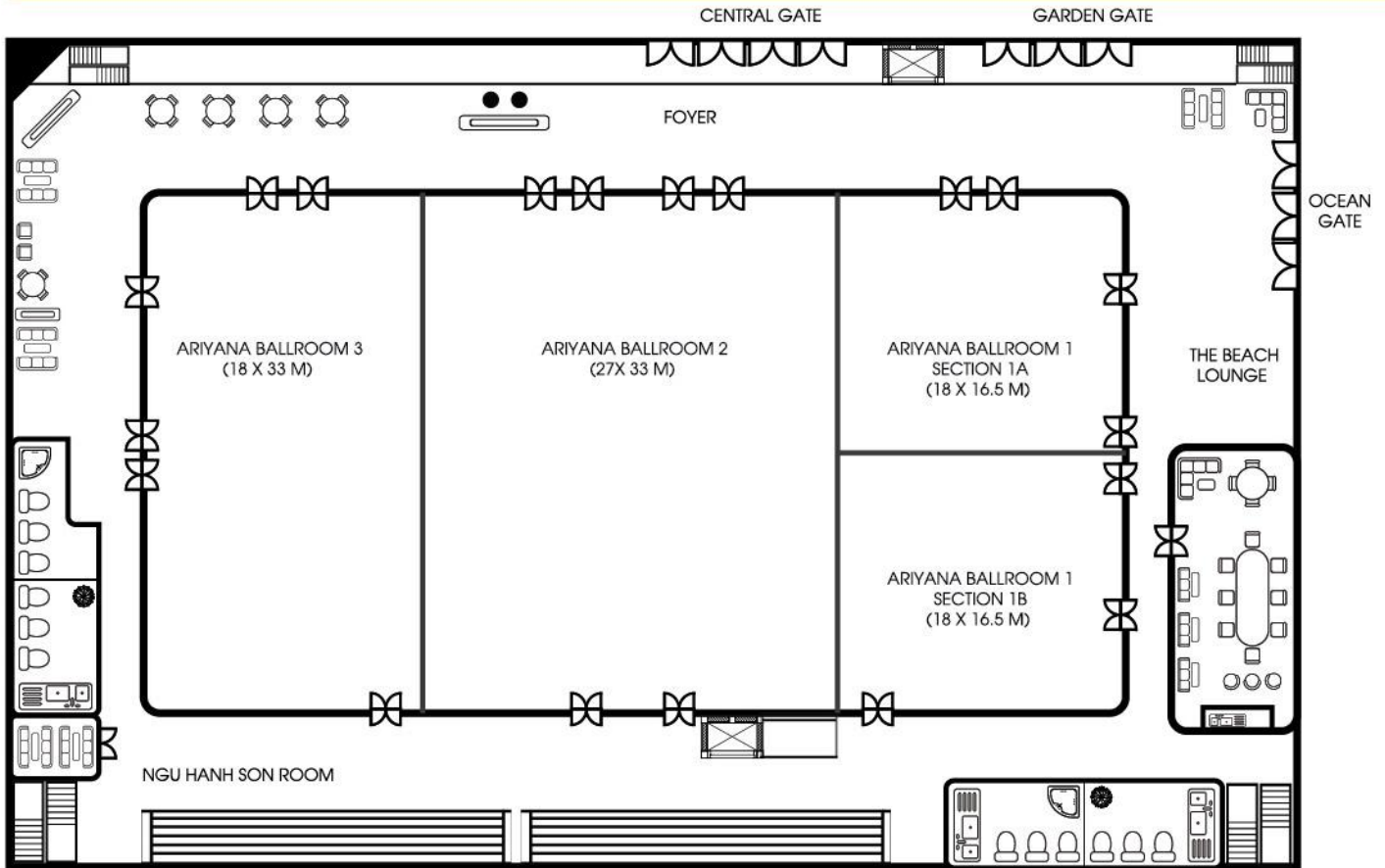

### FUNCTION ROOM FLOOR PLAN (2ND FLOOR)

- ❶ HOI AN ROOM I (8.5 x 8.9 m)
- ❷ HOI AN ROOM II (8.5 x 8.9 m)
- ❸ MY SON ROOM I (8.5 x 8.9 m)
- ❹ MY SON ROOM II (8.5 x 8.9 m)
- ❺ HUE ROOM (5.4 x 11.9 m)
- ❻ PHONG NHA ROOM (5.4 x 11.9 m)
- ❼ HA LONG ROOM LONG (5.4 x 11.9 m)

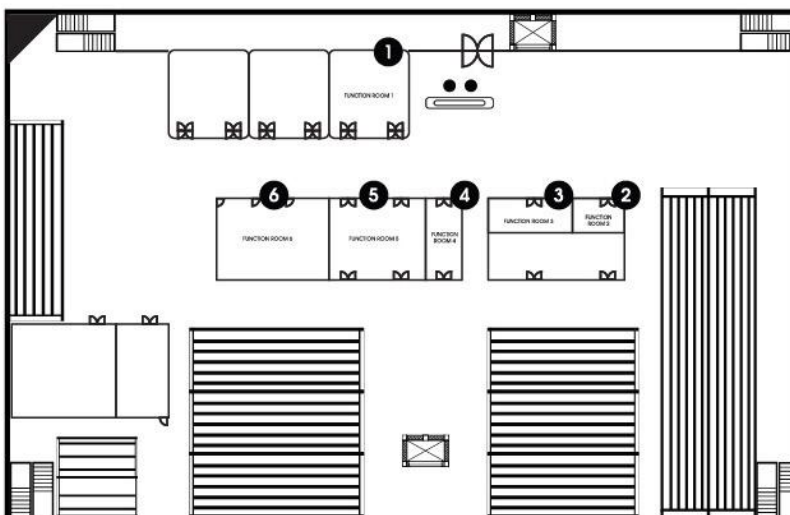

### FUNCTION ROOM FLOOR PLAN (GROUND FLOOR)

- ❶ FUNCTION ROOM 1 (9 x 10.5 m)
- ❷ FUNCTION ROOM 2 (5 x 4 m)
- ❸ FUNCTION ROOM 3 (9 x 4 m)
- ❹ FUNCTION ROOM 4 (9 x 4 m)
- ❺ FUNCTION ROOM 5 (9 x 11 m)
- ❻ FUNCTION ROOM 6 (9 x 11 m)